

ALARM SYSTEM

- Alarm system is a device for detecting the vibration. When the sensor detects vibration or movement with the ignition switch in the OFF or LOCK position and the system is set, the alarm is activated.
- The alarm sounds and alarm indicator flashes and the turn signal lights flashes for about 10 seconds when the alarm system detects vibration caused by contact or movement.
- The alarm sounds and alarm indicator flashes and the turn signal lights flashes for about 60 seconds when the alarm system detects a substantial change in the motorcycle posture. After the alarm sounds for 60 seconds, the alarm system will be reset in that posture.

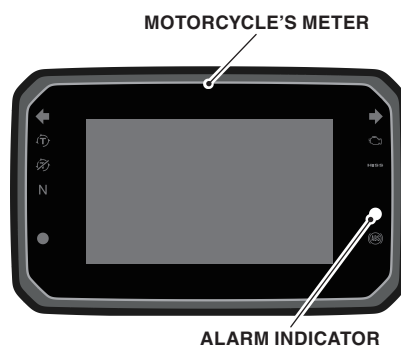
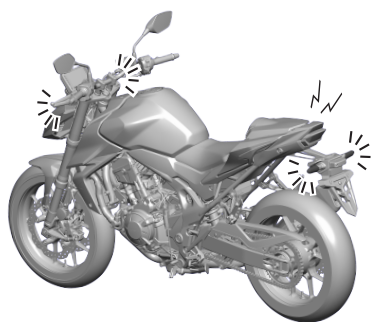
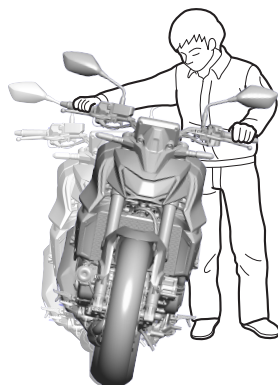
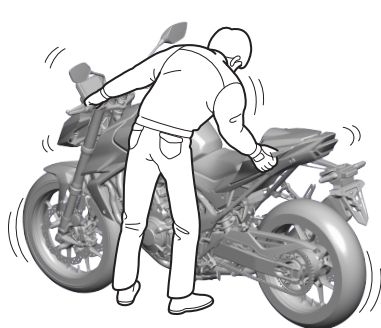

- If the ignition switch is left in the OFF or LOCK position for more than 10 days, the alarm system will no longer operate. To reset the system, turn the ignition switch to the ON position once.
- The alarm system uses low-intensity radio waves. It may affect medical equipment such as a cardiac pacemaker.

NOTICE

When the battery in the motorcycle is weak, the alarm system may not function.

Alarm System Genuine Accessory User's Guide

SETTING THE ALARM SYSTEM (USING THE ALARM TRANSMITTER)

1. Turn the ignition switch to the OFF or LOCK position.

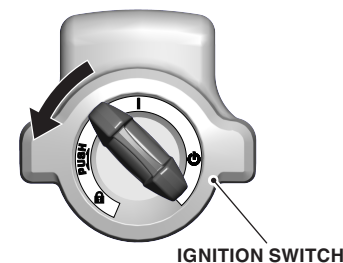

2. Push the SET button. Within a second, the buzzer sounds for 1 time and the turn signal lights flashes 1 time. After 2 seconds, the buzzer sounds 1 time and the alarm indicator flashes 1 time. The alarm system is activated.

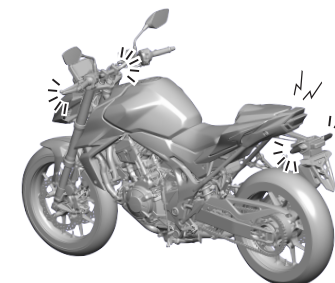
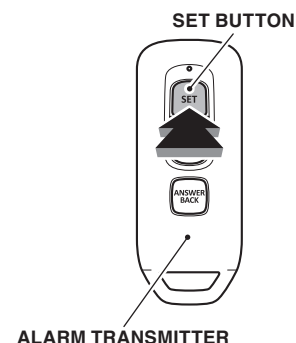

- The alarm indicator flashes while the alarm system activated. The alarm system is cancelled when ignition switch is turned to the ON position.



Alarm System Genuine Accessory User's Guide

CANCELLING THE ALARM SYSTEM

- Push the UNSET button once or turn the ignition switch ON.

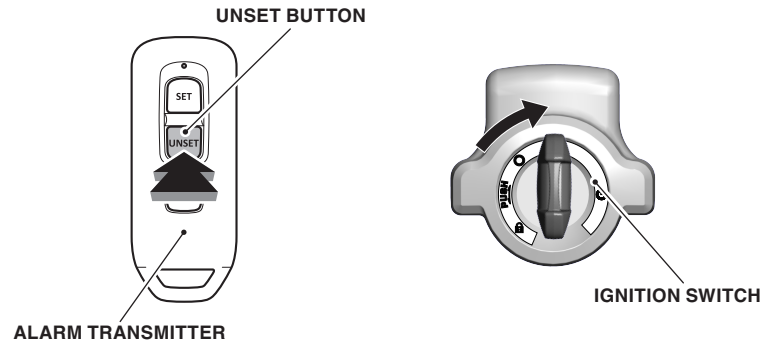

- When the UNSET button is pushed, the buzzer sounds for 2 times, the turn signal lights flashes 2 times, and the alarm indicator flashes 2 times.
The alarm system is cancelled when the ignition switch is turned ON.
If an abnormality is detected, the buzzer sounds for 4 times and the alarm indicator flashes 4 times after 1 second.

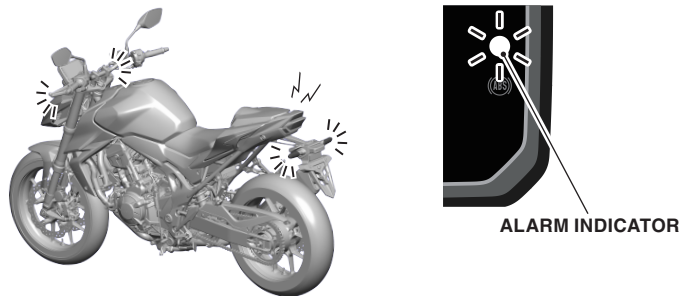

SETTING THE AUTO ALARM FUNCTION

1. Turn the ignition switch ON.

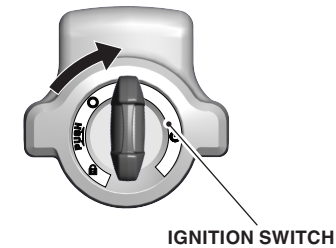

2. Push the SET button 3 times within 10 seconds and turn the ignition switch to the OFF. The buzzer sounds for 1 time.

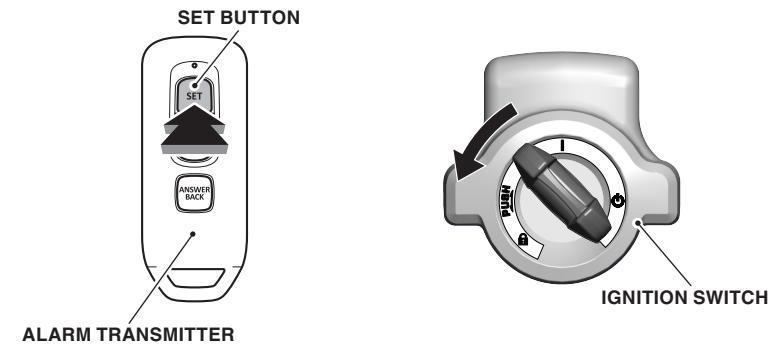

3. Turn the ignition switch ON and turn to the OFF. The auto alarm function is activated.

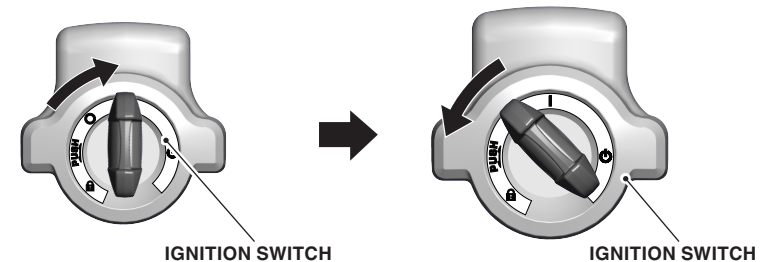

Alarm System Genuine Accessory User's Guide

SETTING THE ALARM SYSTEM (AUTO SET)

1. Turn the ignition switch to the OFF or LOCK position.

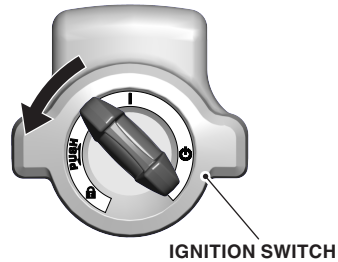

2. The buzzer sounds for 1 time, the turn signal flashes 1 time and the alarm indicator turns on. After 60 seconds, the buzzer sounds 1 time and the alarm indicator turns on and off. The alarm system is activated.

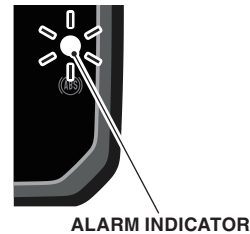
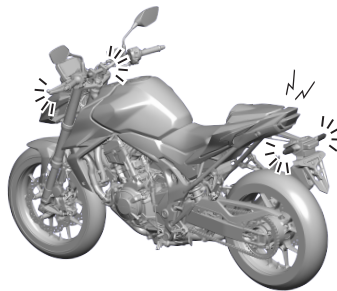

- The alarm indicator flashes while the alarm system activated.
The alarm system is cancelled when ignition switch is turned to the ON position.



CANCELLING THE AUTO ALARM FUNCTION

1. Turn the ignition switch ON.

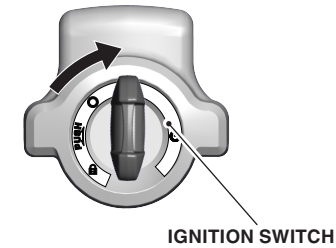

2. Push the SET button 3 times within 10 seconds and turn the ignition switch to the OFF. The buzzer sounds for 2 times.

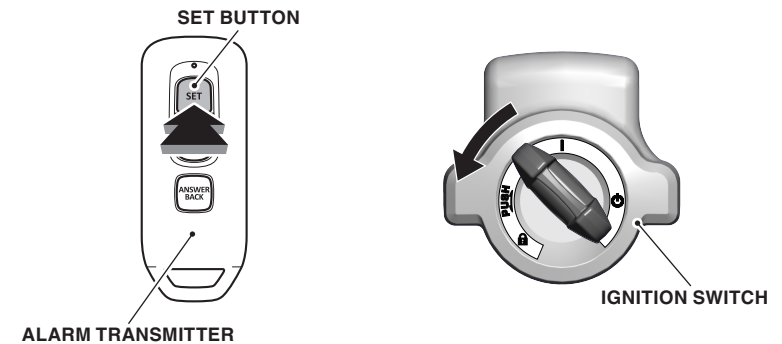

3. Turn the ignition switch ON and turn to the OFF. The auto alarm function is deactivated.

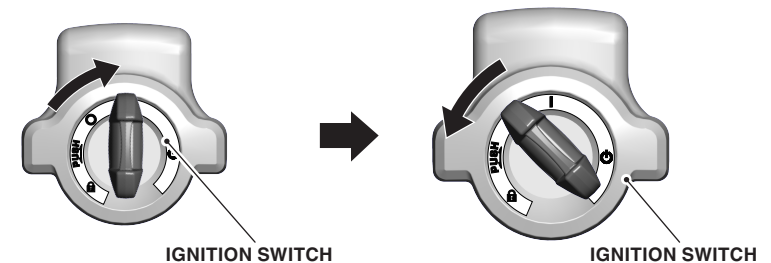

Alarm System Genuine Accessory User's Guide

ADJUSTING THE SENSITIVITY OF ALARM SYSTEM

- You can select 3 sensitivity levels of alarm system.

1. Turn the ignition switch to the OFF position.
2. Perform this step 3 times (within 5 seconds in each time) :
 - Turn the ignition switch ON.
 - Push the SET button of the alarm transmitter 2 times.
 - Turn the ignition switch OFF.(Return to the step for turning the ignition switch ON)

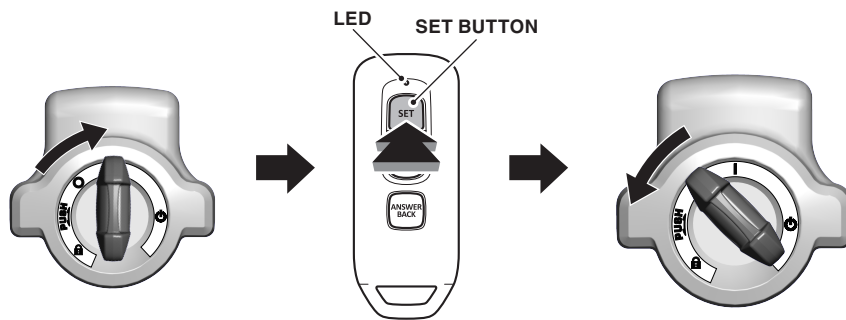

3. Within 5 seconds, turn the ignition switch ON.
Within 5 seconds, push the SET button to select among 3 sensitivity levels of alarm system.
 - 3 times of alarm sound: high sensitivity
 - 2 times of alarm sound: middle sensitivity
 - 1 time of alarm sound: low sensitivityThe alarm indicator lights while setting.



4. Turn the ignition switch to the OFF position to finish setting the sensitivity level.
 - To complete your setting, you need to go through step 3 within 60 seconds.
 - Make sure that LED on the alarm transmitter is green before setting the sensitivity level. Because if it is red, you cannot set the sensitivity level.

IF THE ALARM SYSTEM DOES NOT OPERATE PROPERLY

- If any of the following situations arise, battery in the motorcycle is discharged or there is a system problem. Remove the battery and see your dealer.

The alarm does not ring.

The alarm rings but fades out.

The alarm system does not stop.

ANSWER BACK SYSTEM

- The answer back system is a device to find the position of your motorcycle. When you push the ANSWER BACK button on the alarm transmitter with the ignition switch in the OFF or LOCK position, your motorcycle informs you the position by sounding the buzzer and flashing the turn signal lights.

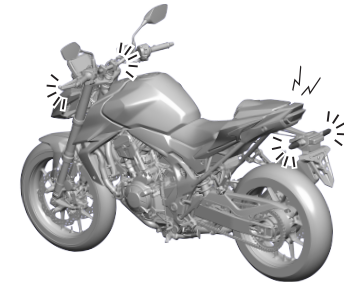
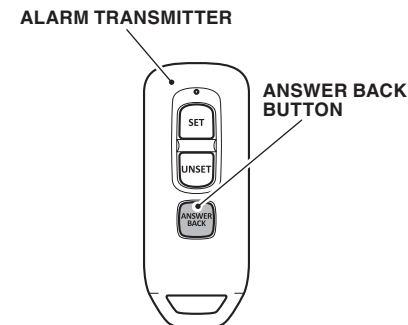

- The answer back system uses low-intensity radio waves. It may affect medical equipment such as a cardiac pacemaker.

Alarm System Genuine Accessory User's Guide

OPERATION

- Push the **ANSWER BACK** button on the alarm transmitter.
- Answer back system will not function when the ignition switch is in the **ON** position.

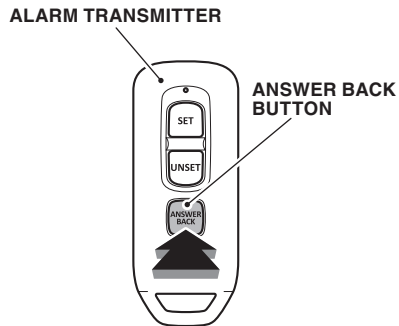

- If the ignition switch is left in the **OFF** or **LOCK** position for more than 10 days, the alarm system will no longer operate. To reset the system, turn the ignition switch to the **ON** position once.

NOTICE

When the battery in the motorcycle is weak, the alarm system may not function.

CHANGING THE ANSWER BACK BUZZER SOUND PATTERN

- You can select 4 buzzer sound patterns(one of them has no buzzer sound).

1. Perform this step 3 times (within 5 seconds in each time) :

- Turn the ignition switch **ON**.
- Push the **ANSWER BACK** button of the registered alarm transmitter 3 times.
- Turn the ignition switch **OFF**.

(Return to the step for turning the ignition switch **ON**)

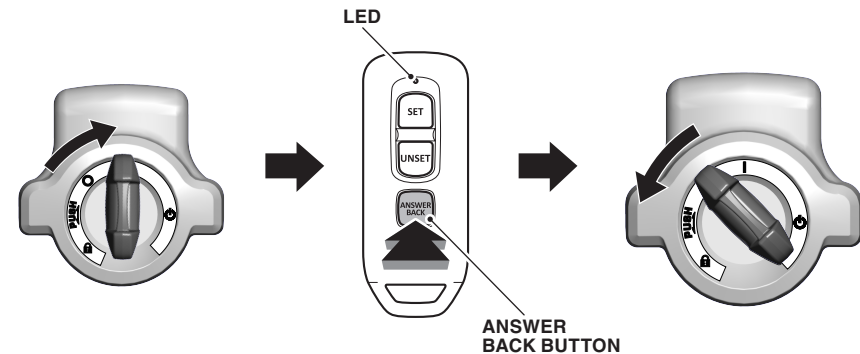

3. Within 5 seconds, turn the ignition switch **ON**.

Within 5 seconds, push the **ANSWER BACK** button to select among 4 buzzer sound patterns. (one of them has no buzzer sound)

4. Turn the ignition switch to the **OFF** position to finish setting the buzzer sound patterns

- To complete your setting, you need to go through step 3 within 60 seconds.
- Make sure that **LED** on the alarm transmitter is **green** before setting the sensitivity level. Because if it is **red**, you cannot set the sensitivity level.

Alarm System Genuine Accessory User's Guide

REPLACING THE ALARM TRANSMITTER BATTERY

- When the alarm transmitter battery begins to get weak, it may take several pushes on the button to operate the alarm system or answer back system, and the LED will get dim. Replace the battery soon as possible.

We recommend to see your dealer for this service.

Battery type: CR1632

1. Remove the upper case by carefully prying on the edge with a coin or a screw driver.
 - Wrap a coin or a screwdriver with a protective cloth to prevent scratching the alarm transmitter.
 - Do not touch the circuit or terminal. This may cause problems.
 - Be careful to avoid scratching the waterproof covering or allowing dust to enter.
 - Do not forcefully disassemble the alarm transmitter body.

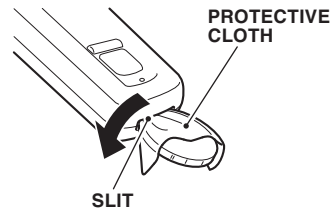

2. Replace the old battery with a new battery with the negative (-) side facing up.
3. Snap the two halves of the alarm transmitter back together.
 - Make sure that upper and lower cases are set in the right position.

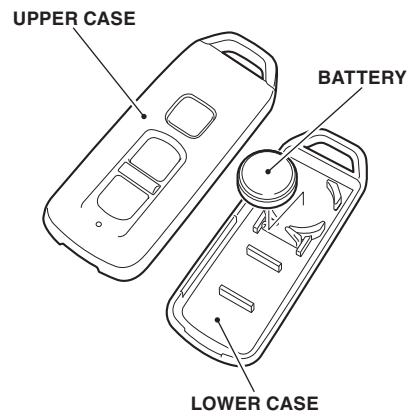

⚠ WARNING

Chemical Burn Hazard: do not swallow battery.
If swallowed, the battery can cause severe internal burns and even death.

- Keep battery away from children and battery compartment securely closed.
- If the battery compartment does not close securely, stop using the product and keep it away from children.
- Immediately seek medical attention if a child may have swallowed battery.

REGISTRATION OF ALARM TRANSMITTERS

- You can register additional alarm transmitters.

1. Turn the ignition switch to the OFF position.
2. Perform this step 3 times (within 5 seconds in each time) :
 - Turn the ignition switch ON.
 - Push the **ANSWER BACK** button of the registered alarm transmitter 1 time.
 - Turn the ignition switch OFF.(Return to the step for turning the ignition switch ON)

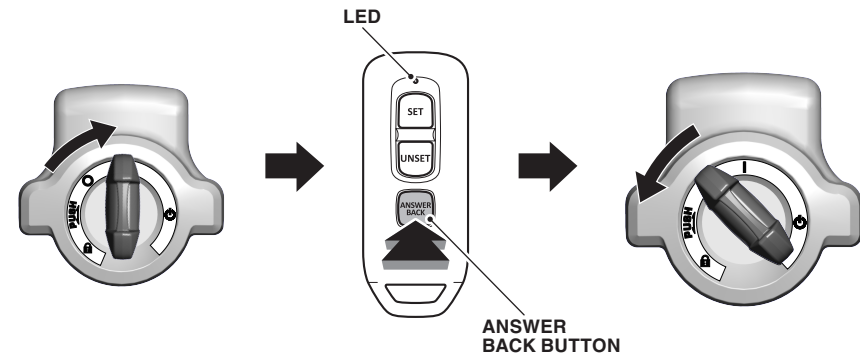

3. Within 5 seconds, turn the ignition switch ON.
Within 5 seconds, push the ANSWER BACK button 1 time.
The buzzer sounds 2 times.
4. Push the ANSWER BACK button on new alarm transmitter within 10 seconds, the buzzer sounds 2 times.
5. Turn the ignition switch to the OFF position to finish setting the sensitivity level.
 - Up to 3 new alarm transmitters can be registered.
 - From the 4th registration, the oldest registration will be deleted.